

Private Land and Ownership Identification SCOBEY - (48105b)

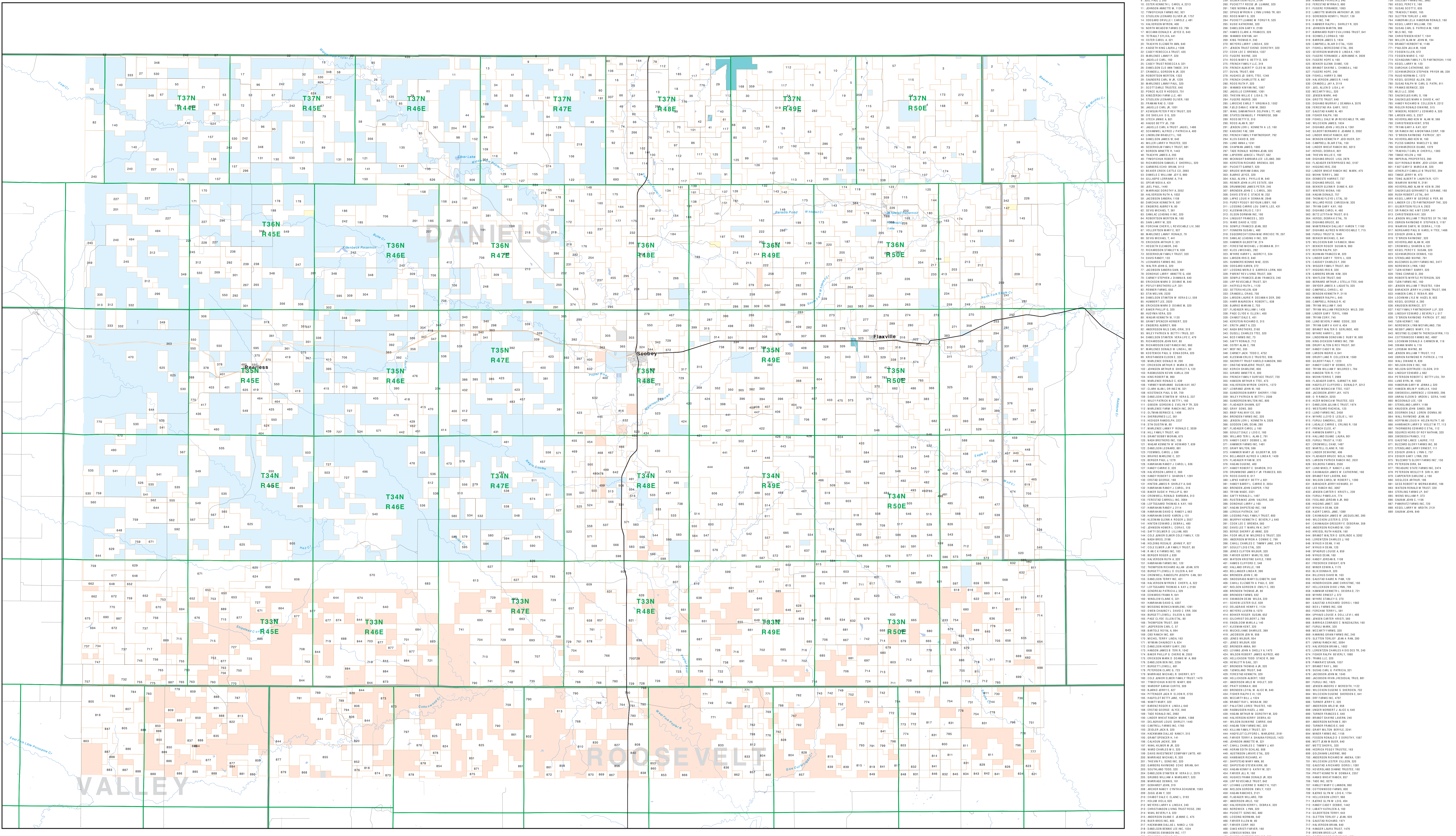

Legend for Private, Forest Service, Bureau of Land Management, National Park Service, Other Federal Land, Fish and Wildlife Service, State Lands, Local Govt, Native American, MFWP - WMA, Lake/Reservoir, Interstate, Secondary Highway, Highway, Road, Primitive Road, River, Stream/Creek, Intermittent Creek, Township, County Border, Fish Wildlife & Parks Wildlife Management Area.

NOTES: No all rights items may appear on this map. Factors shown on the map do not imply public access to any lands. The land status data displayed on this map may not be complete and may contain errors in boundary locations and/or coding. DISCLAIMER: This map is a derivative product of the Montana Department of Fish, Wildlife & Parks. It is not a warranty of the State of Montana. The State of Montana is not responsible for any errors or omissions in this map. The State of Montana is not responsible for any damages or losses resulting from the use of this map. The State of Montana is not responsible for any claims or liabilities arising from the use of this map. The State of Montana is not responsible for any claims or liabilities arising from the use of this map.

The private land data were developed for the Montana Cadastral Database Project. The data were developed through a cooperative effort between the Montana Department of Fish, Wildlife & Parks (MFWP) and the Montana Department of Natural Resources and Conservation (DNRC). The DNRC is the lead agency for the Montana Cadastral Database Project. The MFWP is the lead agency for the Montana Department of Fish, Wildlife & Parks. The DNRC is the lead agency for the Montana Department of Natural Resources and Conservation. The MFWP is the lead agency for the Montana Department of Fish, Wildlife & Parks. The DNRC is the lead agency for the Montana Department of Natural Resources and Conservation.

USGS 100,000 Scale Quadrangle Index table with columns for Easting and Northing coordinates and corresponding grid numbers.